



# Exhibit A: Required Public Access Area and Corridors

## Total Dedicated Public Access Area

-  Shoreline Public Access Area (71,140 sf)
-  Eastern Pedestrian Connection (4,148 sf)
-  Public Access Area Previously Dedicated under BCDP Permit No. M1988.016.02 (41,000 sf)

## Other Dedicated Area

-  Public Right-of-Way

## Required Corridors

-  View Corridor
-  Central Access Corridor

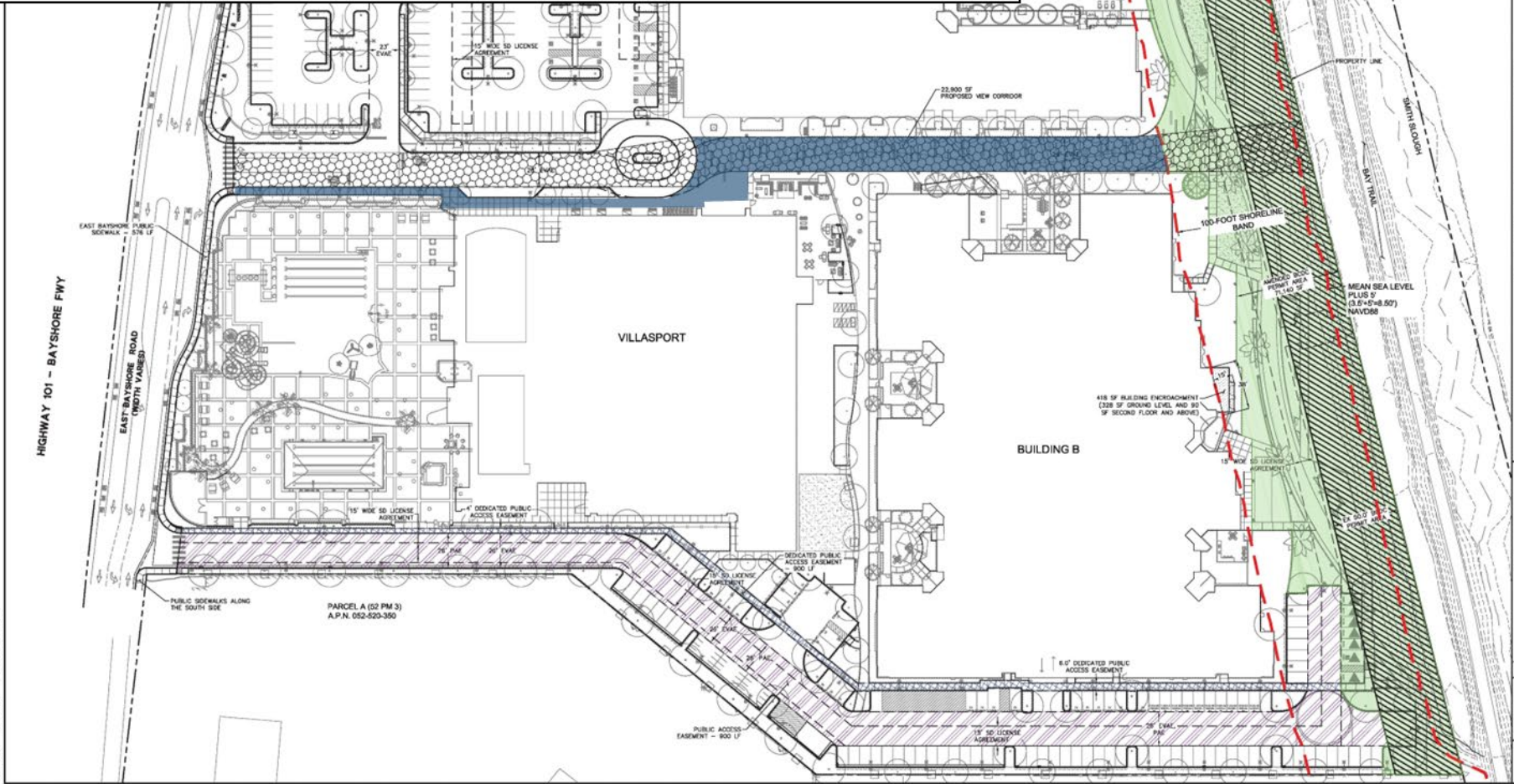

© BKF Engineers  
100 CALIFORNIA ST.  
SUITE 600  
SAN MATEO, CA 94401  
(415) 350-1000  
www.bkf.com

**BKF100+**  
YEARS  
ENGINEERS, SURVEYORS, PLANNERS

CALIFORNIA  
557 EAST BAYSHORE ROAD  
BCDC APPLICATION NO. M1988.016.04 AMENDMENT NO. 4  
SITE PLAN  
SAN MATEO COUNTY  
REDWOOD CITY

Date	8.13.2023	Sheet	1"=20'	
Drawn	AL	Checked	AL	
Reviewed	AL	Approved	AL	
Project No.	202202125	Scale	AS SHOWN	
Plot No.	02-36-23	Author	AL	

**A**

# Exhibit B-1: Shoreline Public Access Area

BCDC Permit No. 2023.002.00

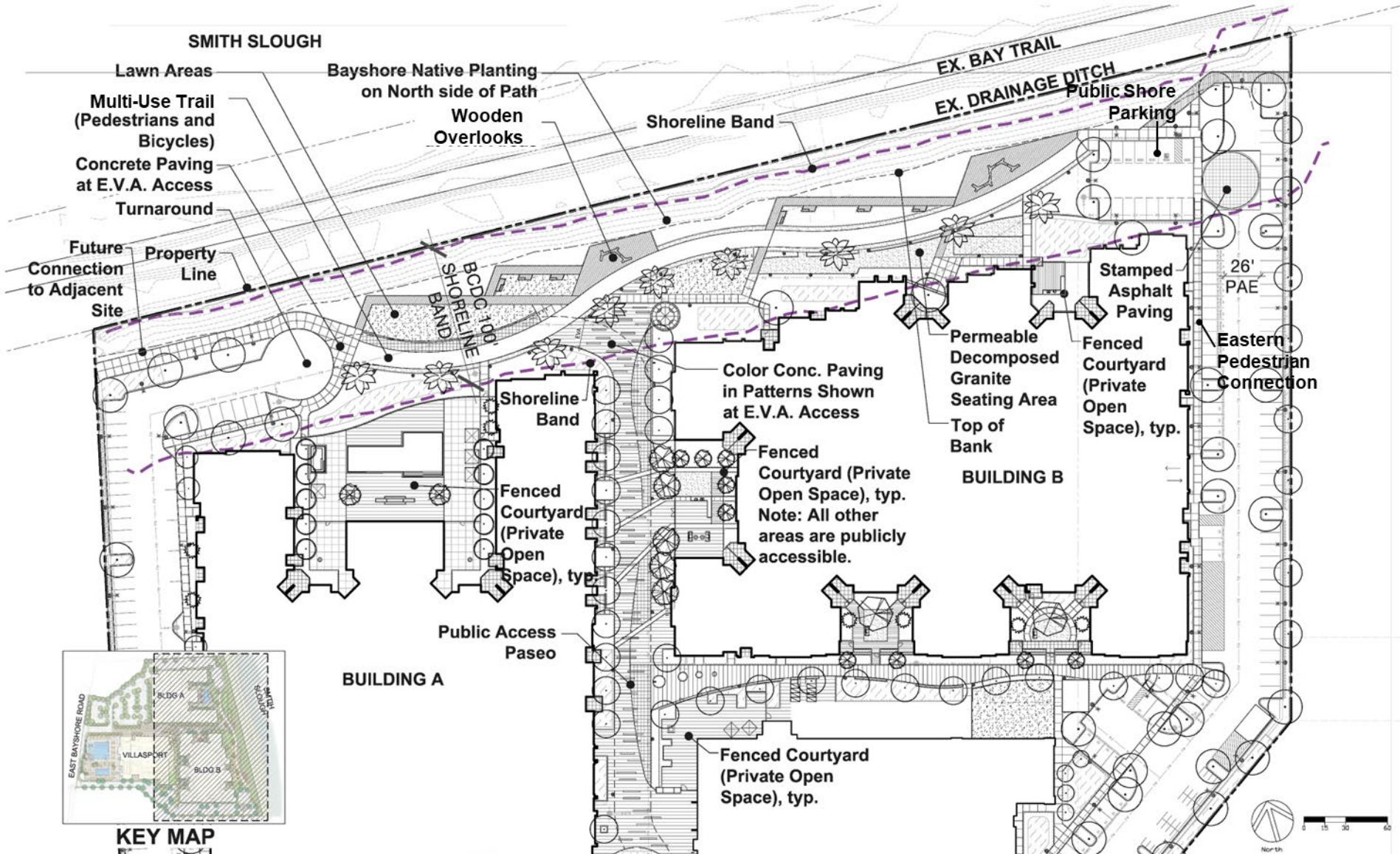

# Exhibit B-2: Shoreline Public Access Area Detail (West)

BCDC Permit No. 2023.002.00

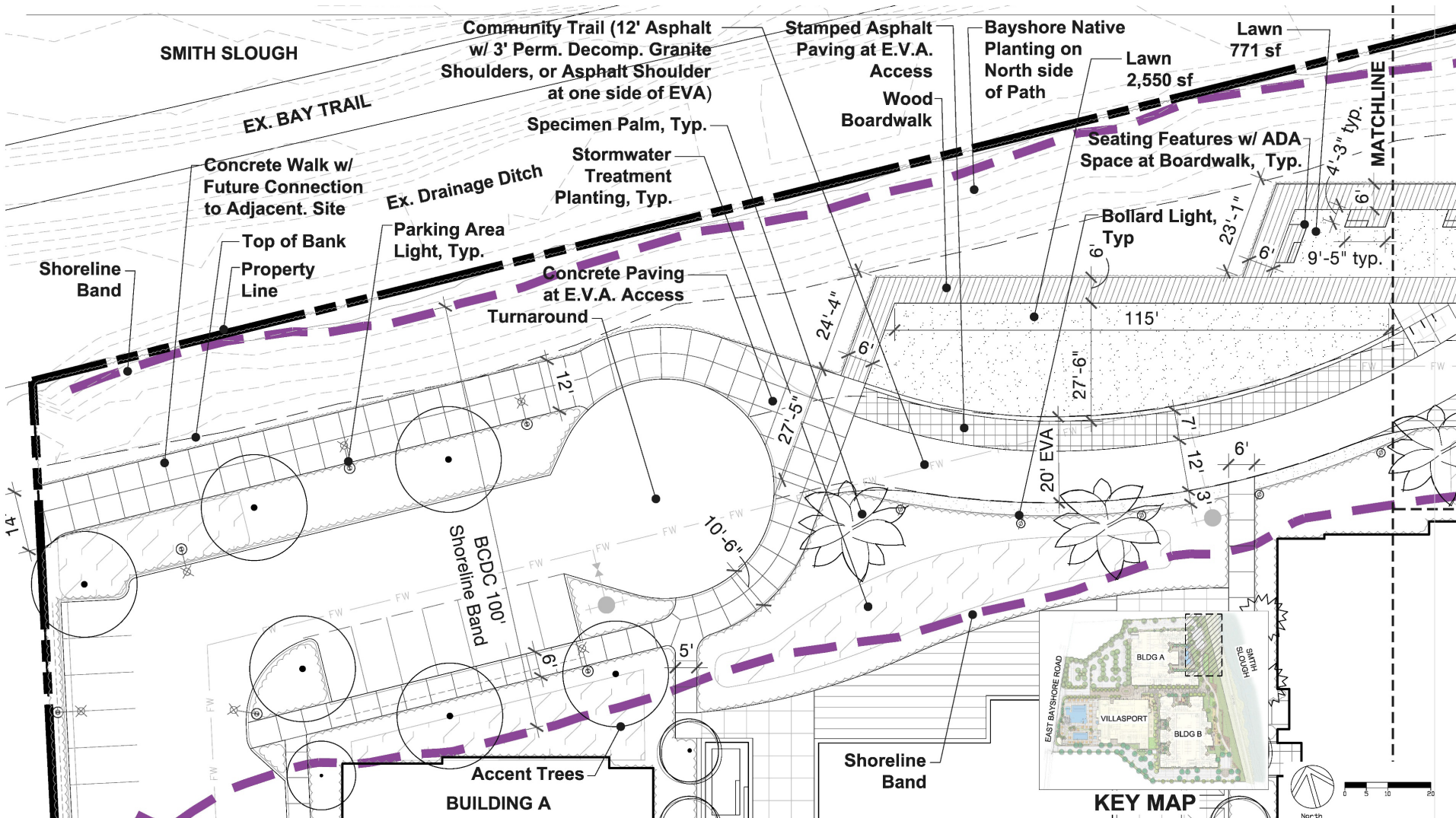

# Exhibit B-3: Shoreline Public Access Area Detail (Center)

BCDC Permit No. 2023.002.00

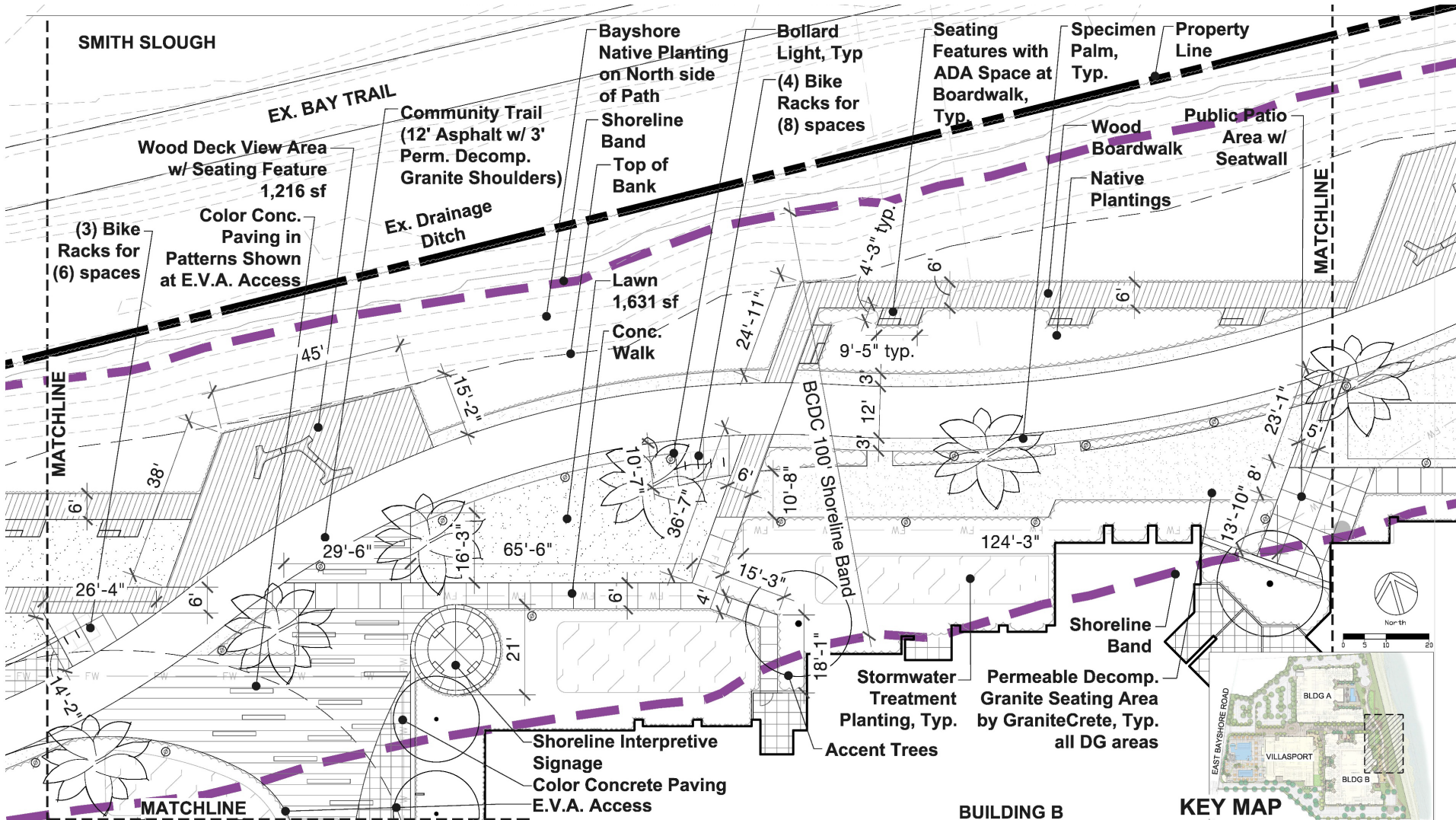





© BKF Engineers

- Phase 2:**
- Eastern portion of Shoreline Public Access Area
  - Permanent Public Shore Parking
  - Eastern Pedestrian Connection
  - Public Right-of-Way

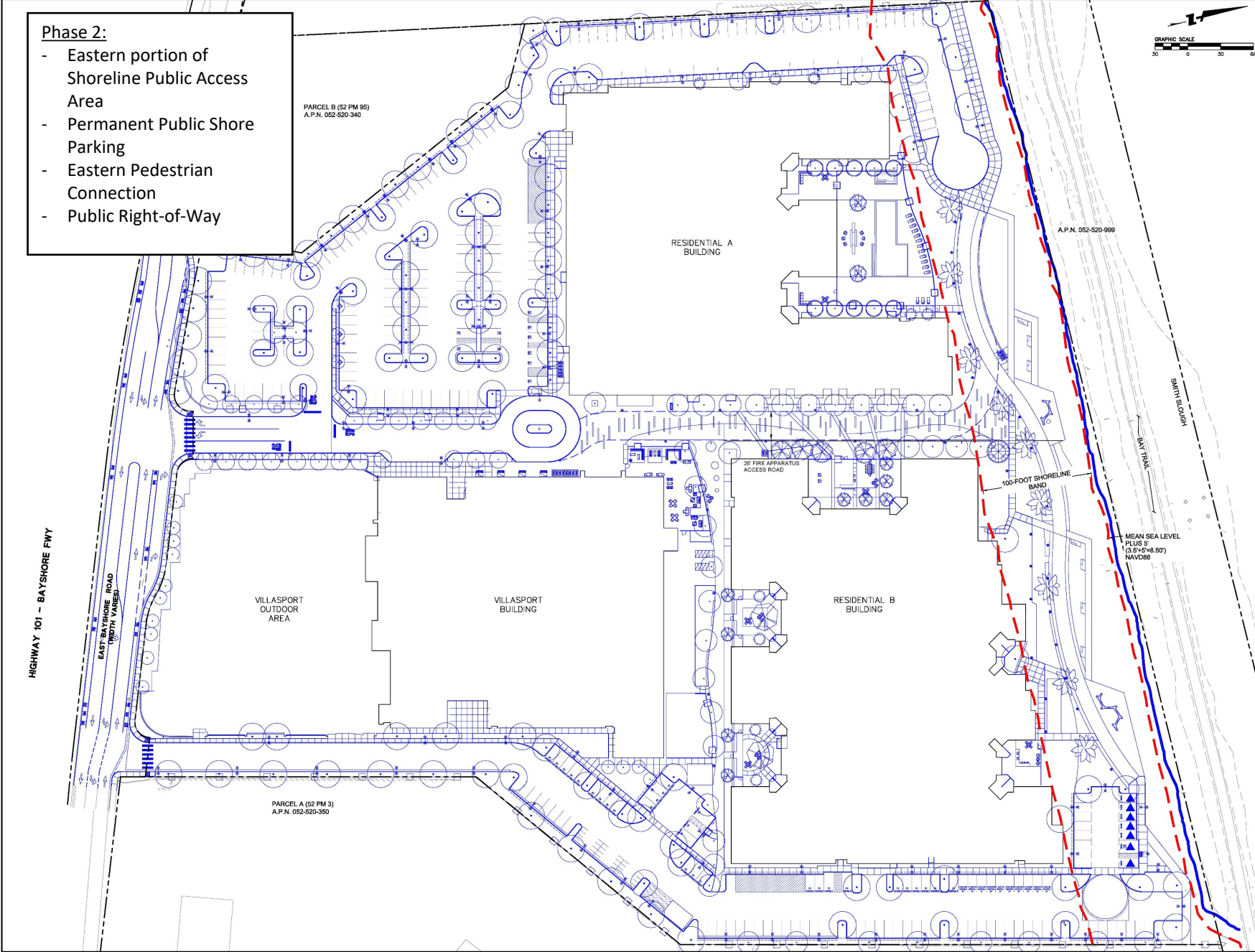
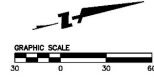

PROJECT NO: 2023.002.00, 2023.002.01, 2023.002.02, 2023.002.03, 2023.002.04, 2023.002.05, 2023.002.06, 2023.002.07, 2023.002.08, 2023.002.09, 2023.002.10, 2023.002.11, 2023.002.12, 2023.002.13, 2023.002.14, 2023.002.15, 2023.002.16, 2023.002.17, 2023.002.18, 2023.002.19, 2023.002.20, 2023.002.21, 2023.002.22, 2023.002.23, 2023.002.24, 2023.002.25, 2023.002.26, 2023.002.27, 2023.002.28, 2023.002.29, 2023.002.30, 2023.002.31, 2023.002.32, 2023.002.33, 2023.002.34, 2023.002.35, 2023.002.36, 2023.002.37, 2023.002.38, 2023.002.39, 2023.002.40, 2023.002.41, 2023.002.42, 2023.002.43, 2023.002.44, 2023.002.45, 2023.002.46, 2023.002.47, 2023.002.48, 2023.002.49, 2023.002.50, 2023.002.51, 2023.002.52, 2023.002.53, 2023.002.54, 2023.002.55, 2023.002.56, 2023.002.57, 2023.002.58, 2023.002.59, 2023.002.60, 2023.002.61, 2023.002.62, 2023.002.63, 2023.002.64, 2023.002.65, 2023.002.66, 2023.002.67, 2023.002.68, 2023.002.69, 2023.002.70, 2023.002.71, 2023.002.72, 2023.002.73, 2023.002.74, 2023.002.75, 2023.002.76, 2023.002.77, 2023.002.78, 2023.002.79, 2023.002.80, 2023.002.81, 2023.002.82, 2023.002.83, 2023.002.84, 2023.002.85, 2023.002.86, 2023.002.87, 2023.002.88, 2023.002.89, 2023.002.90, 2023.002.91, 2023.002.92, 2023.002.93, 2023.002.94, 2023.002.95, 2023.002.96, 2023.002.97, 2023.002.98, 2023.002.99, 2023.002.100

100 CALIFORNIA ST.,  
SAN FRANCISCO, CA 94104  
10 YEARS  
WWW.BKF.COM

ENGINEERS, SURVEYORS, PLANNERS

CALIFORNIA

557 EAST BAYSHORE ROAD

REDWOOD CITY

BCDC ACCESS AND PROJECT PHASING

SAN MATEO COUNTY

NO. 11.0.0022	REV.	DATE	BY	CHECKED	DATE

EX-6

6

# Exhibit D: Special Event Area

BCDC Permit No. 2023.002.00

